

RDSO Sports Association

Name of work: Construction of new Synthetic Tennis Court – Flooding Lighting Arrangement.

A) Schedule of work:

Sl. No.	Description of work	Qty.	Unit	Rate (Rs.)	Amount (Rs.)
1.	Outdoor Flood lighting (LED): 18 LED fixtures (200W of reputed make with five year warranty) on 06 poles of height 13 meter, one double door weather proof distribution board with MS sheet, with MCBs, pipe earthing (3 Meter) , full wiring from distribution board to poles and to the fixtures.	01	Net		
2	Assisting in existing power cable or distribution board relocation (Will be operated only if required)	01	Net		
TOTAL					

Note:

- i) In case of discrepancy between Total Cost in words and figures, amount quoted in words shall be considered.
- ii) Rates to be inclusive of all charges including GST, other taxes, transportation, etc.

B) SPECIAL CONDITIONS FOR THE WORK:

1. Work Experience: Firm should have class 'A' Electrical License.
2. **Warranty Period:** 3 years from the date of completion of installation work other than LED fixtures. Five years warranty for LED fixtures. Any damage/under performance of the system apparently because of inferior quality of material shall be repaired/replaced by the firm to the satisfaction of RDSO SA.
3. **Work completion time:** 90 days
4. **Payment Terms:**
 - a. 95% payment, after satisfactory completion of work.
 - b. 5% amount of the total cost of work shall be withheld towards security deposit. 80% of the security deposit shall be released after completion of 3 years warranty period, subject to satisfactory performance of the flood lighting system and other work executed in the warranty period. Balance security deposit will be released after completion of 5 years warranty period, subject to satisfactory performance of the LED fixtures.
5. The quantity indicated above may vary by 20%. The payment terms and conditions shall remain same for the revised final quantity.
6. Tenderer shall be responsible for payment of all taxes.
7. All material used in construction of court should be of good quality and of reputed brands.
8. In case of any discrepancy or non-compliance w.r.t. above mentioned points is observed, the offer shall be liable to be rejected.
9. RDSOSA reserves the right to accept or reject the offer without assigning any reason. Tenderer shall have no claim in case his offer is rejected.
10. Following facilities shall be provided to the Contractor, free of charge, only towards utilization in execution of work:
 - a. Water and electricity
 - b. Space for storage of construction material
11. Contractor will be responsible for taking all necessary measures for ensuring safety at work place and of its workers. Contractor shall associate with the other contractors of civil and synthetic tennis work in a co-ordinated manner.

C) SUBMISSION OF OFFER:

The offer shall be submitted in sealed envelope covering the details given below:

1. Rate Sheet, as per format given in Schedule of Work, mentioned in point (A) above. Deviations, if any, vis-a-vis schedule of work should be clearly mentioned. If in addition to this Schedule of work, any other related work considered essential is required to be one, then it should be covered within the overall quoted cost.
2. Details of Work Experience along with documentary evidence, as mentioned in point (B) 1 above.
3. Acceptance of conditions mentioned in points (B) 2 to 11 above.
4. Verification of satisfactory compliance for execution of the work shall be done by authorised representative of RDSOSA.

The offer document complete in all respects shall be sent to the following address either by post or handed over in the office of:

G. Pavan Kumar,
Director/Signal-5 &
Secretart/Tennis,
Room No. 206-A,
Annexue-I building,
Signal Directorate,
RDSO, Manak Nagar,
Lucknow – 226011.
Uttar Pradesh.

Last date for receiving the offer shall 19.12.2019 till 16.00 hrs.

(G.Pavan Kumar)
Secretary/Tennis &
Director/Signal



Figure 1 Proposed Site location

Flood Lighting: Three LED fittings of 200W on each pole, total 600W on each pole

Gross Wattage: 6 Pole x 600 W = 3600 W

Swimming Pool

Pump House

Existing drain to provide removable grill

Existing Boundary Wall

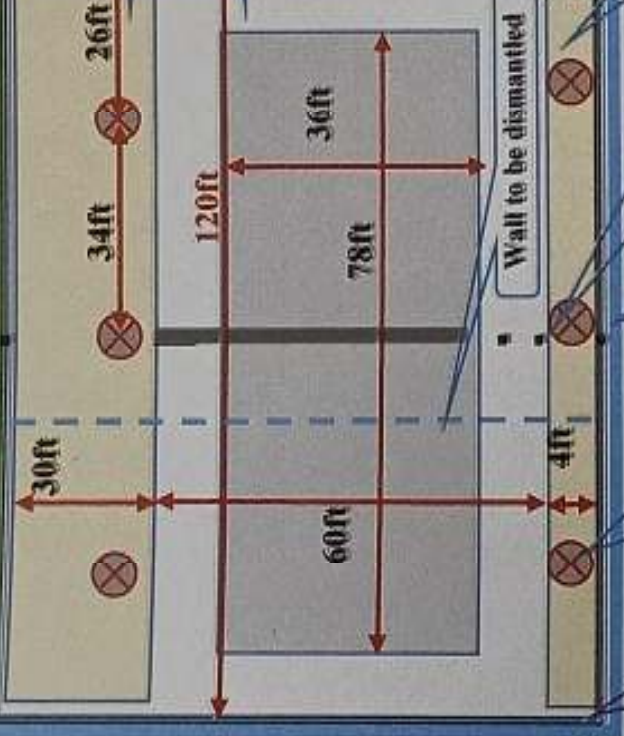

Existing Tennis Complex

120ft

10ft

Wall to be dismantled

Yellow Area: Interlocking with floor Tiles & Covered by Shed & placed 4 Concrete benches

Proposed site for New Tennis Court

Existing drain, to be to be closed with earth material

Wire Mesh Separator

Existing drain to be provided with grill

34ft



Old Drain

Yellow Area: Interlocking with floor Tiles

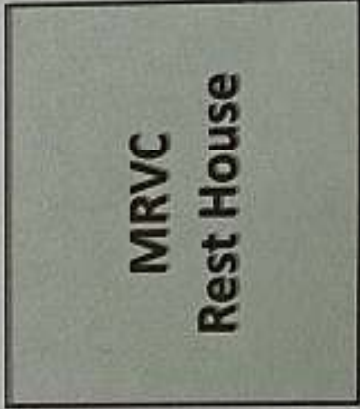

MRVC Rest House

Road

Light Pole

New Boundary Wall 10ft Height + 5ft Mesh

Existing Boundary Wall of 3ft height To be dismantled within court Area

New Drain

1ft height x 6" width Separator

Sump

Wall to be dismantled