

ISO9001:2008	Document no. RDSO/SPN/204/2011	Version: 1.1	Date effective: 04.02.2014
Document name: Double walled corrugated HDPE duct for Railway signaling			



**SPECIFICATION**  
for  
**DOUBLE WALLED CORRUGATED HDPE DUCTS**  
for  
**RAILWAY SIGNALLING**

**SPECIFICATION No. RDSO/SPN/204/2011**

**Version 1.1**

**Issued by**

**SIGNAL DIRECTORATE  
RESEARCH, DESIGNS & STANDARDS ORGANISATION  
MINISTRY OF RAILWAYS  
MANAK NAGAR  
LUCKNOW – 226 011**

Prepared By: JE/Signal	Checked By: DD/Signal	Issued BY: ED Signal	1 o f 2 3

ISO9001:2008	Document no. RDSO/SPN/204/2011	Version: 1.1	Date effective: 04.02.2014
Document name: Double walled corrugated HDPE duct for Railway signaling			

## AMENDMENTS

Specification Number	Version	Amendment	Amendment Details	Effective Date
RDSO/SPN/204/2011	Version 0.0 (Draft)	-	First issue (Draft)	02/02/2011
RDSO/SPN/204/2011	Version 0.1 (Draft)	-	Cl. 6.2, 6.10, 9.1, 9.2, Annexure A & Table-2 Modified	01/06/2011
RDSO/SPN/204/2011	Version 1.0	-	First issue	29/09/2011
RDSO/SPN/204/2011	Version 1.1	-	Clause 14.0 Modified	04.02.2014

Prepared By: JE/Signal	Checked By: DD/Signal	Issued BY: ED Signal	2 o f 2 3

ISO9001:2008	Document no. RDSO/SPN/204/2011	Version: 1.1	Date effective: 04.02.2014
Document name: Double walled corrugated HDPE duct for Railway signaling			

## **TABLE OF CONTENTS**

<b>Clause No.</b>	<b>Item</b>	<b>Page No.</b>
0.0	Foreword	04
1.0	Scope	05
2.0	Terminology	05
3.0	Abbreviations	05
4.0	General Requirements	05-06
5.0	Requirement of Raw material used for the DWC HDPE Duct	06
6.0	Requirement of DWC HDPE Duct	06-08
7.0	DWC DUCT Accessories	08
8.0	Packing Requirement	09
9.0	Type tests	09
10.0	Acceptance tests	10
11.0	Routine Test	10
12.0	Inspection	10-11
13.0	Sampling	11
14.0	Warranty	11
15.0	Rejection	12
16.0	Information to be supplied by Purchaser	12
Annexure – A	Dimension of the DWC Duct	13
Annexure – B	Compression Test	13
Annexure – C	Impact Test	14
Annexure – D	Bending Test	14
Annexure – E	Oxidation Induction Test Procedure	15
Annexure – F	Resistance to Flame Propagation Test Procedure	16-17
Annexure – G	Anti Rodent Test Procedure	17
Annexure – H	External Influences Test Procedure	18
TABLE 1	Raw Material Requirement	19
TABLE 2	Dimensions	19
TABLE 3	Scale of Sampling	20
TABLE 4	Time of Exposure of the Sample to the Flame	20
Figure -1	Impact Test Apparatus	21
Figure -2	Bending Test Apparatus	22
Figure -3	Resistance to Flame Propagation Test Apparatus	23

Prepared By: JE/Signal	Checked By: DD/Signal	Issued BY: ED Signal	3 o f 2 3

ISO9001:2008	Document no. RDSO/SPN/204/2011	Version: 1.1	Date effective: 04.02.2014
Document name: Double walled corrugated HDPE duct for Railway signaling			

**GOVERNMENT OF INDIA  
MINISTRY OF RAILWAYS  
(RAILWAY BOARD)**



**INDIAN RAILWAY STANDARD SPECIFICATION  
for  
DOUBLE WALLED CORRUGATED HDPE DUCTS  
for  
RAILWAY SIGNALLING**

**0.0 FOREWORD**

0.1 This specification is issued under the fixed serial number followed by the year of adoption as standard or in case of revision, the year of latest revision.

0.2 This specification requires reference to the following specifications.

- (i) IS:14930 Pt.-I : General requirements of Conduit system for Electrical and Communication installation
- (ii) IS:14930 Pt.-II : Particular requirements of Conduit system for Electrical and Communication installation
- (iii) IS:2530 : Method for test for Polyethylene moulding materials and polyethylene compounds.
- (iv) IS:7328 : HDPE materials for moulding and extrusion
- (v) IS:12063 : Classification of degrees of protection provided by enclosures of electrical equipment
- (vi) IS:11000(Pt-2/Sec1) : Glow-Wire Test and Guidance, Test Methods for Fire Hazard Testing
- (vii) ASTM D 1693 : Test method for environmental stress – cracking of ethylene plastics
- (viii) ASTM D 638 : Standard test method for tensile properties of plastic
- (ix) ASTM D 790 : Test method for flexural properties of Unreinforced and Reinforced Plastics and Electrical Insulating Materials.
- (x) ASTM D 2240 : Standard Test method for Rubber property.
- (xi) ASTM D 648 : Standard Test method for deflection temperature of plastic under flexure load in the Edgewise Position.

Prepared By: JE/Signal	Checked By: DD/Signal	Issued BY: ED Signal	4 of 23

ISO9001:2008	Document no. RDSO/SPN/204/2011	Version: 1.1	Date effective: 04.02.2014
Document name: Double walled corrugated HDPE duct for Railway signaling			

0.3 Whenever reference to any specification appears in this document, it shall be taken as a reference to the latest version of that specification unless the year of issue of the specification is specifically stated.

## 1.0 SCOPE

This document specifies the requirement and testing for Double Walled Corrugated (DWC) HDPE Ducts buried underground including ducts & duct fittings for protection wherever required for all types of Signalling Cables.

## 2.0 TERMINOLOGY

Terminology as defined in IS: 14930 shall be followed.

## 3.0 ABBREVIATIONS

- ASTM : American Society for Testing & Materials.
- CC : Cubic Centimeter.
- DSC : Differential Scanning Calorimeter
- DTA : Differential Thermal Analyzer
- DWC : Double Walled Corrugated
- ESCR : Environmental Stress Crack Resistance
- FTIR : Fourier Transform Infrared Spectroscopy
- g : Gram
- HDPE : High Density Polyethylene.
- Hr : Hour
- IS : Indian Standard.
- Kg : Kilograms
- MFI : Melt Flow Index.
- mm : Millimeter
- OIT : Oxidation Induction Test
- SPN : Specification Provisional Number.
- UV : Ultra Violet.

## 4.0 GENERAL REQUIREMENTS

- 4.1 The DWC Duct shall consist of two layers, the outer layer will be corrugated and the inner layer shall be plain and smooth.
- 4.2 DWC Duct and conduit fittings within the scope of this specification shall be so designed and constructed that in normal use their performance is reliable and without danger to the user or surroundings.
- 4.3 When assembled in accordance with manufacturer's instruction as part of a conduit system, they shall provide mechanical protection to Signalling Cables contained therein.

Prepared By: JE/Signal	Checked By: DD/Signal	Issued BY: ED Signal	5 of 23

ISO9001:2008	Document no. RDSO/SPN/204/2011	Version: 1.1	Date effective: 04.02.2014
Document name: Double walled corrugated HDPE duct for Railway signaling			

- 4.4 Within the conduit system there shall be no sharp edge, burrs or surface projections which are likely to damage insulated conductors or cables or inflict impurity to the installer or user.
- 4.5 The protective properties of the joint between conduit and conduit fittings shall be not less than that declared for the conduit system.
- 4.6 The DWC Duct and fittings shall withstand the stresses likely to occur during transport, storage, recommended installation practice and application.
- 4.7 The DWC duct shall be supplied in continuous length in coil form or straight length, suitable for shipping and handling purpose.
- 4.8 For conduit systems that are assembled by means other than threads, the manufacturer shall indicate whether the system can be disassembled and if, so, how this can be achieved.

## 5.0 REQUIREMENTS OF RAW MATERIALS USED FOR THE DWC HDPE DUCTS

- 5.1 The base HDPE resin used for the outer and inner layer of the DWC HDPE Duct shall conform to any designation of IS:7328 or to any equivalent standard meeting the requirements given in Table No. 1, when tested as per the standards given therein. However, the manufacturers shall furnish the designation for the HDPE resin as per IS: 7328 as applicable.
- 5.2 The anti-oxidants used shall be physiologically harmless.
- 5.3 None of the additives shall be used separately or together in quantities as to impair long term physical and chemical properties of the duct.
- 5.4 Single pass rework material of the same composition produced from the manufacturer's own production may be used and it shall not exceed 10% in any case.
- 5.5 The raw material used for extrusion shall be dried to bring the moisture content to less than 0.1%.
- 5.6 Suitable UV stabilizers shall be used only for manufacture of the non black coloured HDPE duct to protect against UV degradation, when stored in open for minimum 8 months period. The purchaser may ask for UV content test. The test result for UV Content test by FTIR method from any recognized laboratory shall be accepted and the Hindered Amine Light Stabiliser shall be minimum 0.15 %. UV Content test need not to be conducted in case of UV Stabilized raw material is used.

## 6.0 REQUIREMENT OF DWC HDPE DUCTS

- 6.1 **Visual Requirement:** The ducts shall be checked visually for ensuring good workmanship that the ducts shall be free from holes, breaks and other defects. The ends shall be cleanly cut and shall be square with axis of the ducts.

Prepared By: JE/Signal	Checked By: DD/Signal	Issued BY: ED Signal	6 of 23

ISO9001:2008	Document no. RDSO/SPN/204/2011	Version: 1.1	Date effective: 04.02.2014
Document name: Double walled corrugated HDPE duct for Railway signaling			

- 6.2 Colour:** The colour of the duct viz. Green, Orange, Blue, Yellow, Brown, Violet, Grey and Red. The purchaser shall specify the colour of the duct at the time of ordering.
- 6.3 Dimensions:** The dimensions of the DWC HDPE Ducts shall be as given in table- 2. Any other sizes other than those mentioned in Table- 2 shall be as per the agreement between the buyer and the seller. Compliance shall be checked as per procedure given in Annexure- A
- 6.4 Standards Length:** Duct up to 50 mm OD nominal size shall be supplied in standard length of 100 mtr.  $\pm 1\%$  or 6 mtr  $\pm 1\%$  and all other sizes will be supplied in standard length of 6 mtr.  $\pm 1\%$
- 6.5 Compression Strength:** The conduit system shall have adequate mechanical strength. Conduits when bent or compressed either during, or after, installation according to manufacturer's instructions, shall not crack and shall not be deformed to such an extent that introduction of the insulated conductors or cables becomes difficult or that the installed insulated conductors, or cables are likely to be damaged while being drawn in. Compliance may be checked with the application of force which shall be at least 450 N, when reaching the deflection of 5%. Test shall be conducted in accordance to the method given in Annexure- B
- 6.6 Impact Strength:** The conduit system shall have adequate mechanical strength. Conduits when exposed to impact either during, or after, installation according to manufacturer's instructions, shall not crack and shall not be deformed to such an extent that introduction of the insulated conductors or cables becomes difficult or that the installed insulated conductors, or cables are likely to be damaged while being drawn in. Compliance may be checked by ensuring there shall be no crack allowing the ingress of light or water between the inside and outside after the test. Test shall be conducted in accordance to the method given in Annexure- C
- 6.7 Bending Strength:** The conduit system shall have adequate mechanical strength. Conduits when bend either during, or after, installation according to manufacturer's instructions, shall not crack and shall not be deformed to such an extent that introduction of the insulated conductors or cables becomes difficult or that the installed insulated conductors, or cables are likely to be damaged while being drawn in. During the test sample shall not flatten Compliance shall be checked by passing a ball having a diameter equal to 95% minimum inner diameter specified in table-of the sample declared by the manufacturer, through the sample whilst it is bent around the test apparatus. Test shall be conducted in accordance to the method given in Annexure- D
- 6.8 Oxidation Induction Test (OIT):** The OIT is a qualitative assessment of the level (or degree) of stabilization of material. The induction time in oxygen when tested with an Aluminum pan as per method given in Annexure- E shall not be less than 30 minutes.

Prepared By: JE/Signal	Checked By: DD/Signal	Issued BY: ED Signal	7 of 23

ISO9001:2008	Document no. RDSO/SPN/204/2011	Version: 1.1	Date effective: 04.02.2014
Document name: Double walled corrugated HDPE duct for Railway signaling			

**6.9 Resistance To Flame Propagation:** Non flame propagating ducts shall have adequate resistance to flame propagation. Samples of DWC HDPE Ducts shall be checked by applying a 1KW flame. Test shall be conducted in accordance to the method given in Annexure- F Combustion shall stop within 30 Seconds.

**6.10 Anti Rodent Properties:** Safety of ducts from the direct attack of subterranean organism anti rodent material is of utmost importance. These ducts shall be evaluated for their safety against rodents before laying them in the fields. Test shall be conducted in accordance to the method given in Annexure- G

**6.11 Resistance to External Influences on DWC HDPE Duct Accessories:** The accessories in Clause 7.0 shall be tested for external influences as per IS-12063 for ingress of dust & ingress of water. DWC Duct systems when assembled in accordance with the manufacturer's instructions shall have adequate resistance to external influences according to the classification declared by the manufacturer with a requirement of IP 67. Test shall be conducted in accordance to the method given in Annexure- H

**6.12 Marking Identification:** The conduit shall be prominently marked at regular intervals along their length of preferably 1m but not longer than 3m using indelible ink with following.

- Manufacturers name
- Specification No.
- Name of the duct with size
- Lot No. of the Product
- Date of manufacture
- Product Length
- Purchaser's Name/ symbol

## **7.0 DWC DUCT ACCESSORIES**

7.1 The following accessories are required for jointing the ducts and shall be supplied along with the ducts against specific orders. The manufacturers shall provide complete procedure and method for installation of the accessories. The required quantities of accessories are to be mentioned by the purchasing authority in the purchase order.

### **7.1.1 Plastic Coupler:**

The coupler shall be of Push-fit type with O-ring. It is used for jointing two or more ducts. The design of this shall be simple, easy to install and shall provide air tight and water tight joint between the two ducts. The coupler shall insure that the two ducts are butted smoothly without any step formation in the inner surface. The coupler may be straight, bands, T-joints type as per requirements of purchaser.

Prepared By: JE/Signal	Checked By: DD/Signal	Issued BY: ED Signal	8 o f 2 3



ISO9001:2008	Document no. RDSO/SPN/204/2011	Version: 1.1	Date effective: 04.02.2014
Document name: Double walled corrugated HDPE duct for Railway signaling			

### 7.1.2 End Cap:

This cap made of suitable plastic material shall be fitted on the both ends of duct, coil after manufacturing the duct. This shall avoid entry of dust, mud and rainwater into the duct during the transit & storage.

- 7.2 The dimensions of accessories shall be suitable for joining the ducts of dimension as per Cl: 6.3

## 8.0 PACKING REQUIREMENT

Stores shall be supplied in standard size for delivery and shall be so packed as to permit convenient handling and to protect against loss or damage during transit and storage.

## 9.0 TYPE TESTS

- 9.1 Complete DWC Duct systems for each offered size of the duct on fresh samples shall be subjected to following tests minimum after 240 hrs of manufacture.

- |   |                |
|---|----------------|
| a) Visual Requirement   | (Cl. No. 6.1)  |
| b) Color  | (Cl. No. 6.2)  |
| c) Dimension  | (Cl. No. 6.3)  |
| d) Standards length   | (Cl. No. 6.4)  |
| e) Compression Strength   | (Cl. No. 6.5)  |
| f) Impact Strength  | (Cl. No. 6.6)  |
| g) Bending Strength   | (Cl. No. 6.7)  |
| h) Oxidation Induction Test                                       | (Cl. No. 6.8)  |
| i) Resistance to Flame Propagation                                | (Cl. No. 6.9)  |
| j) Anti rodent  | (Cl. No. 6.10) |
| k) Resistance to External Influences on DWC HDPE Duct accessories | (Cl. No. 6.11) |

- 9.2 The Oxidation Induction Test, Resistance to Flame Propagating Test, Anti Rodent Test on the DWC duct and Resistance to External Influences on DWC HDPE Duct accessories given in Cl. No. 6.8, 6.9, 6.10 & 6.11 respectively may be conducted at the manufacturer's laboratory by inspecting authority or at any recognized laboratory.

- 9.3 The raw material tests of the DWC duct given in Cl. No. 5.0 Table-1 for each grade of raw material shall be conducted. Test may be conducted at the manufacturer's laboratory by inspecting authority or at any recognized laboratory.

- 9.4 Unless otherwise specified each tests shall be made on three new samples.

Prepared By: JE/Signal	Checked By: DD/Signal	Issued BY: ED Signal	9 o f 2 3

ISO9001:2008	Document no. RDSO/SPN/204/2011	Version: 1.1	Date effective: 04.02.2014
Document name: Double walled corrugated HDPE duct for Railway signaling			

## 10.0 ACCEPTANCE TESTS

10.1 The following test shall be carried after 240 hrs of manufacture on samples selected from the lot as per sampling plan given in Cl 13.0

- |    |                                 |               |
|----|---------------------------------|---------------|
| a) | Visual Requirement              | (Cl. No. 6.1) |
| b) | Color                           | (Cl. No. 6.2) |
| c) | Dimension                       | (Cl. No. 6.3) |
| d) | Standards length                | (Cl. No. 6.4) |
| e) | Compression test                | (Cl. No. 6.5) |
| f) | Impact test                     | (Cl. No. 6.6) |
| g) | Bending test                    | (Cl. No. 6.7) |
| h) | Resistance to Flame Propagation | (Cl. No. 6.9) |

10.2 The Resistance to Flame Propagating Test on DWC HDPE Duct given in Cl. No. 6.9 may be conducted at the manufacturer's laboratory by inspecting authority or at any recognized laboratory.

10.3 Unless otherwise specified each tests shall be made on three new samples.

## 11.0 ROUTINE TESTS

11.1 The following tests be carried out by the manufacturer after 240 hrs of manufacture:-

- |    |                                 |               |
|----|---------------------------------|---------------|
| a) | Visual Requirement              | (Cl. No. 6.1) |
| b) | Color                           | (Cl. No. 6.2) |
| c) | Dimension                       | (Cl. No. 6.3) |
| d) | Standards length                | (Cl. No. 6.4) |
| e) | Compression test                | (Cl. No. 6.5) |
| f) | Impact test                     | (Cl. No. 6.6) |
| g) | Bending test                    | (Cl. No. 6.7) |
| h) | Resistance to Flame Propagation | (Cl. No. 6.9) |

11.2 The Resistance to Flame Propagating Test on DWC HDPE Duct given in Cl. No. 6.9 may be conducted at the manufacturer's laboratory by inspecting authority or at any recognized laboratory.

11.3 The Density and Melt Flow Index tests on raw material of the DWC duct given in Cl. No. 5.0 Table-1 for each grade of raw material shall be conducted.

## 12.0 INSPECTION

12.1 All the gauges/ test & measuring instruments shall be under calibration control at the time of inspection and proof to this office shall be produced.

Prepared By: JE/Signal	Checked By: DD/Signal	Issued BY: ED Signal	1 0 o f 2 3

ISO9001:2008	Document no. RDSO/SPN/204/2011	Version: 1.1	Date effective: 04.02.2014
Document name: Double walled corrugated HDPE duct for Railway signaling			

- 12.2 Inspection and testing shall be carried out by the inspecting authority nominated by the purchaser to ensure that all the requirements of this specification are complied with for the acceptance of the materials offered by the supplier for inspection.
- 12.3 The purchaser or his nominee shall have free access to the works of the manufacturer and to be present at all reasonable times and shall be given facilities by the manufacturer to inspect the manufacturing of the duct at any stage of manufacture. He shall have the right to reject whole or part of any work or material that does not conform to the terms of this specification or any equivalent specification or requirement applicable and may order the same to be removed / replaced or altered at the expense of the manufacturer. All reasonable/complete facilities considered necessary by the inspecting authorities for the inspection of the ducts shall be supplied by the manufacturer free of cost.
- 12.4 The manufacturer shall supply the duct samples and samples of the raw materials free of charge as required by the inspecting authority and shall at his own cost prepare and furnish the necessary test pieces and appliances for such testing as may be carried out at his own premises in accordance with this specification. Failing the existence of facilities at his own premises for the prescribed tests, the manufacturer shall bear the cost of carrying out the tests in an approved laboratory, workshop or test house.

### 13.0 SAMPLING

- 13.1 All the length of same nominal size, similar construction and class manufactured from the same material under essentially similar conditions of production shall be grouped together to constitute a lot.
- 13.2 For judging the conformity of a lot to the requirements of the acceptance tests, sampling shall be done for each lot separately. For this purpose, the number of lengths to be selected at random from the lot shall be in accordance with Table 3.
- 13.3 These lengths will be selected at random from the lot for taking samples. From each of these lengths, sample of duct shall be taken. The length of the sample shall be sufficient so as to provide test pieces of required lengths as laid down in various test clauses.

### 14.0 WARRANTY

The manufacturer shall warrant the material covered by this specification to be free from defects in design, material and workmanship under ordinary use and service, his obligation under this warranty being limited to replace free of cost those parts which shall be found defective. Warranty of Duct should be 24 months from the date of placement in service or 30 month from the date of delivery whichever is earlier.

Prepared By: JE/Signal	Checked By: DD/Signal	Issued BY: ED Signal	1 1 o f 2 3

ISO9001:2008	Document no. RDSO/SPN/204/2011	Version: 1.1	Date effective: 04.02.2014
Document name: Double walled corrugated HDPE duct for Railway signaling			

## 15.0 REJECTION

In case the duct tested and inspected in accordance with this specification, fail to pass the tests or comply with the requirement of the specification, the whole consignment shall be rejected subject to the discretion of the purchaser or his nominee.

## 16.0 INFORMATION TO BE SUPPLIED BY THE PURCHASER

- 16.1 Normally the duct will be supplied as per the standard dimensions and length as mentioned in this document. However purchaser may specify his own dimensions/lengths/packing requirements etc. In such cases necessary tolerance shall also be specified by the purchaser.
- 16.2 Adequate quantity & type of duct accessories shall be supplied along with each lot. Purchasers may specify additional requirement.
- 16.3 Inspecting agency for acceptance of material.
- 16.4 Colour of the Duct.

\*\*\*\*\*

Prepared By: JE/Signal	Checked By: DD/Signal	Issued BY: ED Signal	1 2 o f 2 3

ISO9001:2008	Document no. RDSO/SPN/204/2011	Version: 1.1	Date effective: 04.02.2014
Document name: Double walled corrugated HDPE duct for Railway signaling			

## ANNEXURE – A

### **DIMENSION OF THE DWC DUCT**

- 1.0 Compliance of the outside diameter shall be checked using a ring gauge or vernier caliper or any suitable method.
- 1.1 Compliance of the minimum inside diameter shall be checked by measurement according to two perpendicular diameters on the same section and calculating the average value.
- 1.2 Outside diameter specified are nominal dimensions.
- 1.3 Outside diameter maximum is nominal outside diameter + (0.018 x nominal outside diameter values) rounded off to + 0.1 mm.
- 1.4 Minimum inside diameter is nominal outside diameter divided by 1.33

## ANNEXURE - B

### **COMPRESSION TEST**

- 1.0 Conduits are subjected to a compression test as per IS: 14930 (Pt-II). The tests for conduits shall not be started until 240 hrs after manufacture.
- 1.1 Samples shall be  $200 \pm 5$  mm long.
- 1.2 Before the test the outside and inside diameters of the samples shall be measure as described in clause 6.3
- 1.3 The samples shall be compressed between two flat steel plates having minimum dimensions (100x200x15mm), the length 200 mm being along the length of the sample. The sample shall be compressed at a rate of  $15 \pm 0.5$  mm/min and the load recorded at the vertical deflection equivalent to 5% of the average value of the original inside diameter of the sample.
- 1.4 When reaching the deflection of 5%, the applied force shall be at least 450 N
- 1.5 After the test there shall be no crack allowing the ingress of light or water between the inside and the outside.
- 1.6 The deflection is calculated with the inner diameter but the measurement of the outside diameter may be sufficient. In case of doubt, it will be necessary to measure the inner diameter.

Prepared By: JE/Signal	Checked By: DD/Signal	Issued BY: ED Signal	1 3 o f 2 3

ISO9001:2008	Document no. RDSO/SPN/204/2011	Version: 1.1	Date effective: 04.02.2014
Document name: Double walled corrugated HDPE duct for Railway signaling			

## ANNEXURE – C

### **IMPACT TEST**

- 1.0 Twelve samples of the duct each  $200 \pm 5$  mm in length or fittings are subjected to an impact test as per IS: 14930 (Pt-II) by means of the apparatus shown Figure-1.
- 1.1 The test apparatus shall be placed on a firm flat surface. The samples shall be conditioned in a cold chamber at a temperature of  $-5 \pm 1^\circ\text{C}$  for 2 h. The samples shall be removed from the cold chamber and placed on the veeblock holder of the impact tester as shown in Figure-1.
- 1.2 The striker shall fall once on each sample. The time between removal of the sample from the cold chamber and completion of impact shall not exceed 10 seconds. The impact height and mass shall be as follows.

Nominal Size of Conduit	Mass of Striker (+1% /-0%) kg	Fall Height (+0% /-1%) (mm)	Energy Joules
Up to 60 mm	5	300	15
61 to 90 mm	5	400	20
91 to 140 mm	5	570	28
Above 140 mm	5	800	40

- 1.3 The test sample shall be made on the weakest part of the Duct fittings except that it shall not be applied within 5 mm of any sample entry. Samples of ducts are tested on the center of their length.
- 1.4 After the test, at least in nine of the samples, there shall be no crack allowing the ingress of light or water between the inside and the outside.

## ANNEXURE – D

### **BENDING TEST**

- 1.0 This test shall be carried out on pliable conduits.
- 2.0 The test is made on six samples having an appropriate length as per IS: 14930 (Pt-II). Three samples shall be tested at room temperature; the other three shall be tested at  $-5 \pm 1^\circ\text{C}$ . For the test at  $-5^\circ\text{C}$ , the sample shall be conditioned in a cold chamber for 2 hours. The test apparatus as shown in Figure-2 shall allow to bend the duct with a bending radius equal to the minimum bending radius values specified by the manufacturer. One of the ends of the samples shall be fixed on the test apparatus by means of an appropriate device. The sample is then bent to approximately 90 degree (right angle) and hold.
- 2.1 During the test, the sample shall not flatten. Compliance shall be checked by passing a ball having a diameter equal to 95% minimum inner diameter specified in table-2 of the sample declared by the manufacturer, through the sample whilst it is bent around the test apparatus.

Prepared By: JE/Signal	Checked By: DD/Signal	Issued BY: ED Signal	1 4 o f 2 3

ISO9001:2008	Document no. RDSO/SPN/204/2011	Version: 1.1	Date effective: 04.02.2014
Document name: Double walled corrugated HDPE duct for Railway signaling			

## ANNEXURE – E

### **OXIDATION INDUCTION TEST PROCEDURE**

- 1.0 A short length of completed duct (approximately 30 cm) shall be sealed at the ends and placed in an oven at temperature of  $68 \pm 1$  °C for 8 hours. The sample shall then be allowed to cool at room temperature for at least 16 hrs. The samples shall be clean and dry. The sample shall then be tested by means of a Differential Scanning Calorimeter (DSC) or by Differential Thermal Analyzer (DTA).
- 2.0 Instrument Test Procedure:
  - 2.1 Cell Cleaning: The cell shall be held at approximately 400 °C for 10 minutes in Nitrogen. The cell shall be cleaned after standing over night and between testing of different formulations.
  - 2.2 Temperature Calibration: This has to be done according to the instrument manual. The temperature scale should be adjusted until the determined melting point of pure Indium metal is 156.6 °C at a heat rate of 5°C per minute or any other heat rate as indicated in the manual of the equipment is permitted.
  - 2.3 Aluminum Pan Preparation: Standard aluminum DSC pans as per ASTM D 4565 are required to hold specimens during testing. A fresh pan shall be used for each test.
  - 2.4 Sample preparation: Take the sample weighing about 5 mg from the duct conditioned as indicated above. Position the sample in the center of the pan.
  - 2.5 Nitrogen Purge: Place the sample pan and reference pan in instrument cell. Flush for 5 minutes with cylinder of nitrogen (99.6% extra dry grade) at  $60 \pm 10$  cc per minute.
  - 2.6 Oxidation Test: Rapidly increase the temperature of the sample (20 °C/min or greater) from 100 °C or lower initial temperature to  $199 \pm 1$  °C. After thermal equilibrium is obtained (steady recorder signal) switch to 80 ± 20 cc per minute oxygen flow and simultaneously start time-base recording. The oxygen used for the test should be equivalent to or better than 99.6% extra dry grade.
  - 2.7 Induction Period: The oxygen induction point shall be recorded as time zero, and the chart speed shall be sufficient to provide a clearly discernible slope at the start of the exothermic reaction. The test in the pure dry oxygen atmosphere shall continue until the exothermic peak is produced. The intersection of the tangent of the exothermic sloped line with the extended base line will be drawn. The time from time zero to is intersection point is read from the base line and recorded as the oxidative induction time.

Prepared By: JE/Signal	Checked By: DD/Signal	Issued BY: ED Signal	1 5 o f 2 3

ISO9001:2008	Document no. RDSO/SPN/204/2011	Version: 1.1	Date effective: 04.02.2014
Document name: Double walled corrugated HDPE duct for Railway signaling			

## ANNEXURE – F

### **RESISTANCE TO FLAME PROPAGATION TEST PROCEDURE**

- 1.0 Samples of DWC HDPE Ducts shall be checked by applying a 1KW flame.
- 1.1 A sample of length  $675 \pm 10$  mm is mounted vertically in a rectangular metal enclosure with one open face, as shown in Figure-3-2 in an area substantially free from draughts. The general arrangements is shown in Figure-3
- Mounting is by means of two metal clamps approximately 25mm wide spaced  $550 \pm 10$  mm apart and approximately equidistance from the ends of the sample.
- A steel rod of  $16 \pm 0.1$ mm is passed through the sample. It is rigidly and independently mounted and clamped at upper end to maintain the sample in a straight and vertical position. The means of mounting is such as not to obstruct drops from falling onto the tissue paper.
- A suitable piece of white pinewood board, approximately 10 mm thick, covered with single layer of white tissue paper is positioned on the lower surface of the enclosure.
- The assembly of sample, rod and clamping apparatus is mounted vertically in the center of the enclosure, the upper extremity of the lower clamp being  $500 \pm 10$  mm above the internal lower surface of the enclosure.
- 1.2 The burner is supported so that its axis is  $45 \pm 2^0$  to the vertical. The flame is applied to the sample so that the distance from the top of the burner tube to the sample measured along the axis of the flame is  $100 \pm 10$  mm and the axis of the flame intersects with the surface of the samples at a point  $100 \pm 5$  mm from the upper extremity of the lower clamp, and so that the axis of the flame intersects with the axis of the sample.
- 1.3 The test is carried out on three samples. The flame is applied to the sample for the period specified in Table - 4 and is then removed. During the application of the flame, it shall not be moved except to remove it at the conclusion of the period of the test. After the conclusion of the test and after any burning of the sample has ceased, the surface of the sample is wiped clean by rubbing with a piece of cloth soaked with water.
- 1.4 All three samples shall pass the test. If the sample is not ignited by the flame, it shall be deemed to have passed the test.
- If the sample burns, or is consumed without burning, the sample shall be deemed to have passed the test if after burning has ceased, and after the sample has been wiped in accordance with 1.3 there is no evidence of burning or charring within 50 mm of the lower extremity of the upper and also within 50 mm of the upper extremity of the lower clamp.
- If the sample burns, it shall be deemed to have failed the test if combustion is still in progress 30 seconds after removal of the flame.
- If the tissue paper ignites, the sample shall be deemed to have failed the test. For the parts of the same below the burner, the presence of molten material on the internal or external surfaces shall not entail failure if the sample itself is not burned or charred.

Prepared By: JE/Signal	Checked By: DD/Signal	Issued BY: ED Signal	1 6 o f 2 3



ISO9001:2008	Document no. RDSO/SPN/204/2011	Version: 1.1	Date effective: 04.02.2014
Document name: Double walled corrugated HDPE duct for Railway signaling			

- 2.0 Compliance of DWC HDPE Duct fittings is checked by using the glow wire test IS:11000 (Part 2/Sec 1). The glow wire shall be applied once to each sample in the most unfavourable position of its intended use, with the surface tested in vertical position, at a temperature of 750°C. The sample is deemed to have passed this test if there is no visible flame or sustained glowing or if flames or glowing extinguishes within 30s of the removal of the glow wire.

## ANNEXURE – G

### **ANTI RODENT TEST PROCEDURE:**

The test against rodent may be conducted as per following procedures:

The ducts are to be laid underground in fields and also near urban or rural settlements. Therefore they should be exposed to 3-4 most predominant rodent species inhabiting these locations. The test rodent species may include the lesser bandicoot rat, *Bandicota bengalensis*, The Indian gerbils, *tatera indica*, the soft furred field rats, *Millardia meltada* and the house rats, *Rattus rattus*.

The test ducts should be exposed to these rodent species housed individually in iron mesh cages under laboratory conditions. Only freshly capture rodent are to be utilized for the study. The rodents are first acclimatized in laboratory cages for 7-10 days and then the tests be initiated. For each trial, 3-4 rodents of uniform body weight are to be used for the trial. Two different types of testes may be undertaken for all the ducts.

**Choice Tests:** In this trial the ducts of 15-30 cm length (one sample each of treated and untreated /control sample) are exposed to the test rodents along with food, thus the rodent had a choice between the food and the test duct. This test may be run for longer periods (30-45 days). Tap water should be provided ad libitum to the rodents.

**NO Choice Test:** The rodents are exposed to the test ducts only and no food is given to the rodents during the period of trial. The test ducts (one sample each of treated and untreated /control sample) are to the exposed to the test rodents. This trail may be run for 5-7 days depending upon the health status of starved test rodents. Tap water should be provided ad libitum to the rodents.

Observation on tooth marks, rodent behavior toward exposed ducts, relative extent of damage in treated and untreated samples should be computed for both types of ducts. Health status of test animals in choice and no choice test must also be monitored for the record any ill effect of exposure of treated / control ducts on these animals. Number of cases and the extent of rodent bites / scratch marks in control and anti rodent treated ducts may indicate the relative deterrent/repellent properties of the test ducts.

Prepared By: JE/Signal	Checked By: DD/Signal	Issued BY: ED Signal	17 of 23

ISO9001:2008	Document no. RDSO/SPN/204/2011	Version: 1.1	Date effective: 04.02.2014
Document name: Double walled corrugated HDPE duct for Railway signaling			

## ANNEXURE – H

### **EXTERNAL INFLUENCES TEST PROCEDURE**

- 1.0 The accessories in Clause 7.0 shall be tested for external influences as per IS-12063 for ingress of dust & ingress of water. DWC Pipes systems when assembled in accordance with the manufacturer's instructions shall have adequate resistance to external influences according to the classification declared by the manufacturer with a requirement of IP 67.
- 2.0 Degree of Protection – Ingress of Foreign Solid Objects.
  - 2.1 An assembly is made of DWC Pipes fittings with a short length of DWC Pipes assembled in each entry. Where necessary, the open ends of the assembly are plugged or are not part of the test.
  - 2.2 The assembly shall be tested in accordance with the appropriate test of IS 12063.
  - 2.3 The assembly tested for numeral 6, shall be deemed to have passed the test if there is no ingress of dust visible to normal or corrected vision without magnification.
- 3.0 Degree of Protection – Ingress of Water.
  - 3.1 An assembly is made of a DWC Pipe fittings with a short length of DWC Pipes assembled in each conduit entry. Where necessary, the open end of the DWC Pipe is plugged, or is not part of the test.
  - 3.2 The assembly shall be tested in accordance with the appropriate test of IS 12063.
  - 3.3 The assembly tested for numeral 7 shall be deemed to have passed the test, if there is not sufficient ingress of water to form a drop visible to normal or corrected vision without magnification.

Prepared By: JE/Signal	Checked By: DD/Signal	Issued BY: ED Signal	18 of 23

ISO9001:2008	Document no. RDSO/SPN/204/2011	Version: 1.1	Date effective: 04.02.2014
Document name: Double walled corrugated HDPE duct for Railway signaling			

**Table-1**

**RAW MATERIAL REQUIRMENT (Cl. 5.0)**

S. No.	Parameter	Specified Limit	Test Method
1.	Density	0.940 to 0.958 g/cc at 27°C	IS:2530 or IS:7328
2.	Melt Flow Index	0.2 to 1.1 g/10 min at 190°C, 5 kg load	IS:2530
3.	Tensile Strength at Yield	20 N/mm <sup>2</sup> Minimum	ASTM D 638-IV
4.	Elongation at Break	600 % Minimum	ASTM D 638-IV
5.	Hardness Shore D	Between 60 and 65 units	ASTM D 2240
6.	Environmental Stress Crack Resistance	No cracking after 96 hrs.	ASTM D 1693
7.	Flexural modulus at 1 % strain	690 N/mm <sup>2</sup> minimum	ASTM D 790
8.	Heat Deflection Temperature at 45 g/mm <sup>2</sup>	65 <sup>0</sup> C minimum	ASTM D 648
9.	OIT (in Aluminum Pan)	30 minutes minimum	As per Annexure-E

**Table-2**

**DIMENSIONS (Cl. 6.3)**

Nominal Size (mm)	Outside Diameter (mm)	Outside Diameter Tolerance (mm)	Minimum Inside Diameter (mm)
(1)	(2)	(3)	(4)
40	40	+ 0.8	30
50	50	+ 1.0	37
63	63	+ 1.2	47
75	75	+ 1.4	56
90	90	+ 1.7	67
110	110	+ 2.0	82
120	120	+ 2.2	90
125	125	+ 2.3	94
140	140	+ 2.6	106
160	160	+ 2.9	120
180	180	+ 3.3	135
200	200	+ 3.6	150
225	225	+ 4.1	170
250	250	+ 4.5	188
315	315	+ 5.7	237

Prepared By: JE/Signal	Checked By: DD/Signal	Issued BY: ED Signal	19 of 23
------------------------	-----------------------	----------------------	----------

ISO9001:2008	Document no. RDSO/SPN/204/2011	Version: 1.1	Date effective: 04.02.2014
Document name: Double walled corrugated HDPE duct for Railway signaling			

**Table-3**  
**SCALE OF SAMPLING** (Clause–13.0)

Lot Size	For dimensional requirements		Other Acceptance tests
	Sample size	Permissible Number of Defectives	
(1)	(2)	(3)	(4)
Up to 300	13	0	2
301 to 500	20	0	3
501 to 1000	32	1	4
1001 to 3000	50	2	5
3001 and above	80	3	7

**Table-4**  
**TIME OF EXPOSURE OF THE SAMPLE TO THE FLAME**  
(Clause–6.9)

Material	Thickness (mm)	Flame Application (Tolerances +1 sec.)
Over	Upto	
(1)	(2)	(3)
-	0.5	15
0.5	1.0	20
1.0	1.5	25
1.5	2.0	35
2.0	2.5	45
2.5	3.0	55
3.0	3.5	65
3.5	4.0	75
4.0	4.5	85
4.5	5.0	130
5.0	5.5	200
5.5	6.0	300
6.0	6.5	500

Prepared By: JE/Signal	Checked By: DD/Signal	Issued BY: ED Signal	2 0 o f 2 3

ISO9001:2008	Document no. RDSO/SPN/204/2011	Version: 1.1	Date effective: 04.02.2014
Document name: Double walled corrugated HDPE duct for Railway signaling			

**FIGURE – 1**

**IMPACT TEST APPARATUS**

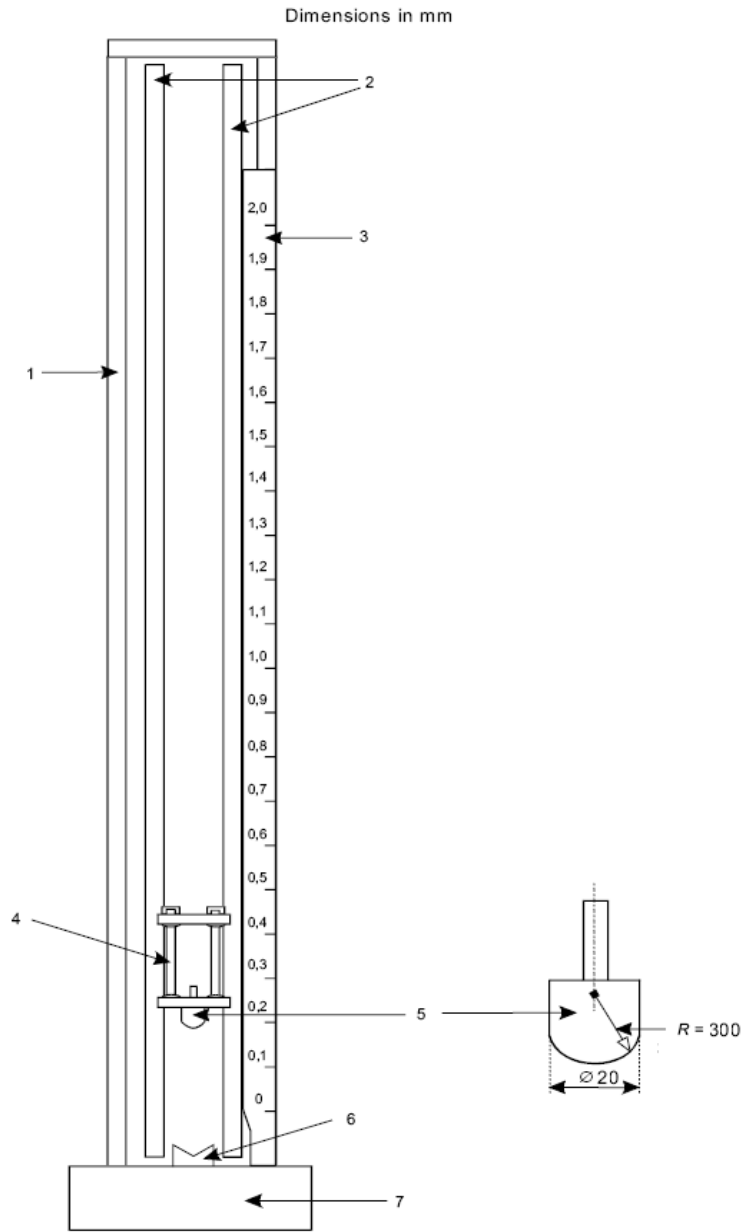

- Key**
- 1 Frame
  - 2 Guide rails
  - 3 Graduated scale
  - 4 Guidance carriage
  - 5 Head of hammer
  - 6 120° vee block
  - 7 Rigid base

NOTE This drawing is not intended to govern design except as regards the dimensions shown

Prepared By: JE/Signal	Checked By: DD/Signal	Issued BY: ED Signal	2 1 o f 2 3

ISO9001:2008	Document no. RDSO/SPN/204/2011	Version: 1.1	Date effective: 04.02.2014
Document name: Double walled corrugated HDPE duct for Railway signaling			

FIGURE – 2

BENDING TEST APPARATUS

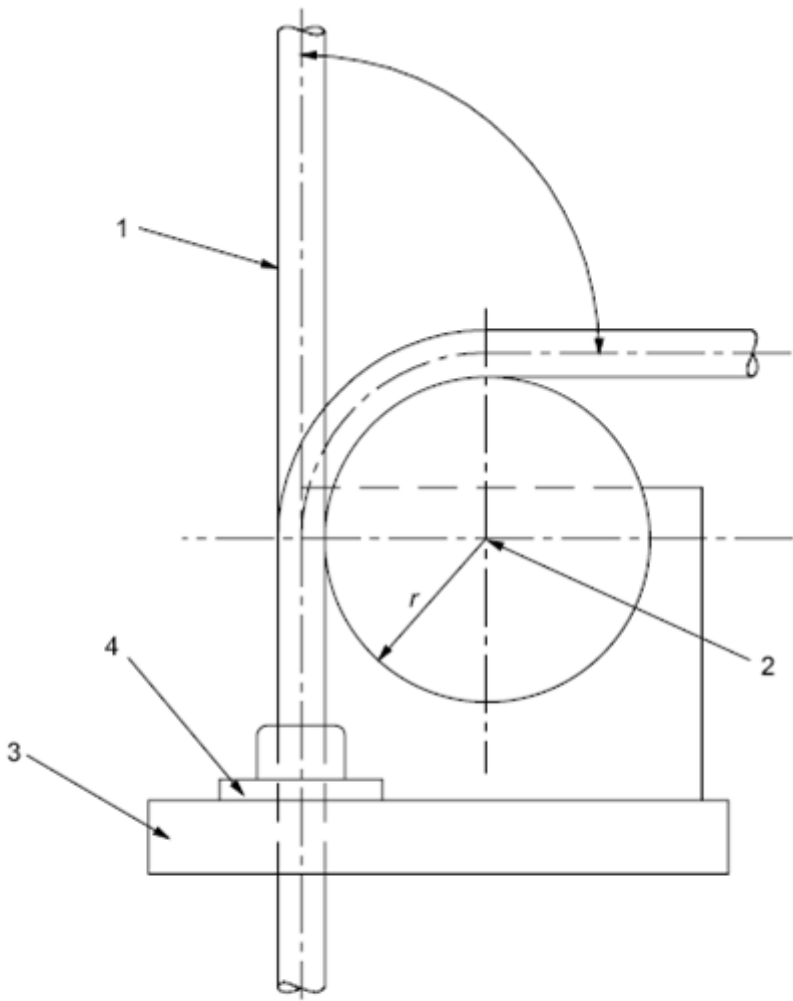

- Key**
- 1 Sample
  - 2 Centre of bending cylinder
  - 3 Support
  - 4 Guide for conduit

Prepared By: JE/Signal	Checked By: DD/Signal	Issued BY: ED Signal	2 2 o f 2 3

ISO9001:2008	Document no. RDSO/SPN/204/2011	Version: 1.1	Date effective: 04.02.2014
Document name: Double walled corrugated HDPE duct for Railway signaling			

**FIGURE – 3**

**RESISTANCE TO FLAME PROPAGATION TEST APPARATUS**

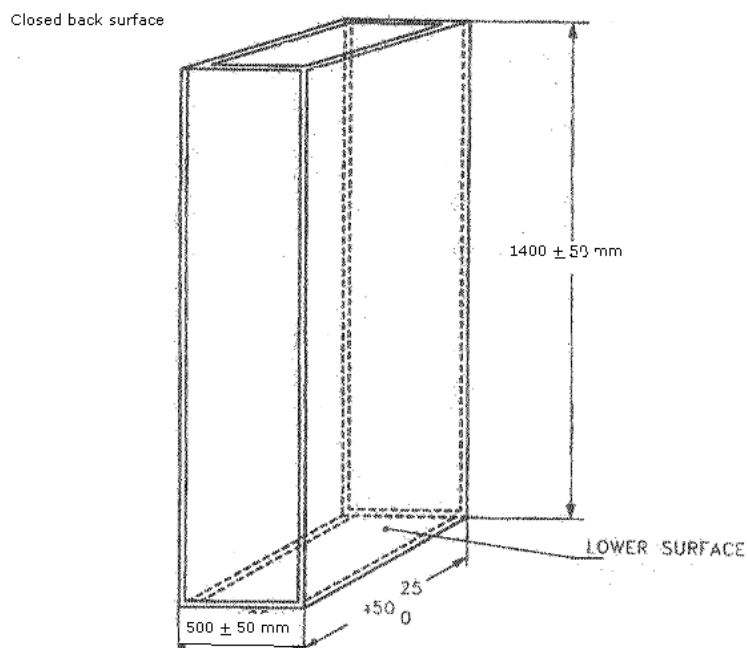

Note: - This drawing is not intended to govern design

ENCLOSURE FOR BURNING TEST

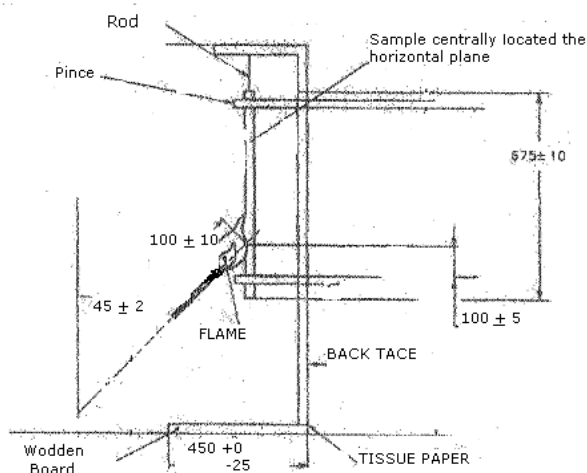

Note: - This drawing is not intended to govern design except as regards the dimension shown

ARRANGEMENT FOR BURNING TEST

Prepared By: JE/Signal	Checked By: DD/Signal	Issued BY: ED Signal	23 of 23



Fax : 91-522-2452332, 032-42100(Rly)  
Telephone : 91-522-2465761  
Mobile : 09794863336  
Rly. : 032-42666,  
E-mail : [dsig8rdso@gmail.com](mailto:dsig8rdso@gmail.com)



Government of India - Ministry of Railways  
**Research Designs & Standards Organisation**  
LUCKNOW – 226 011

No. STS/E/Cable-Laying Practices Vol -IV

Date: 25<sup>th</sup> July 2017

मुख्य संकेत एवं दूरसंचार अभियन्ता, मुख्य संकेत एवं दूरसंचार अभियन्ता (निर्माण), मुख्य संकेत एवं दूरसंचार अभियन्ता ( प्रॉजेक्ट )	Chief Signal & Telecom Engineer, Chief Signal & Telecom Engineer (Const.), Chief Signal & Telecom Engineer (Project)
मध्य रेलवे, मुम्बई सी.एस.टी. – 400 001	Central Rly, Mumbai CST – 400 001
पश्चिम रेलवे, चर्च गेट, मुम्बई – 400 020	Western Rly, Churchgate, Mumbai – 400 020
पूर्व रेलवे, फेयरली प्लेस, कोलकाता – 700 001	Eastern Rly, Fairlie Place, Kolkata – 700 001
दक्षिण पूर्व रेलवे, गार्डन रीच, कोलकाता – 700 043	South Eastern Rly., Garden Reach, Kolkata – 43
उत्तर रेलवे, बड़ौदा हाउस, नई दिल्ली – 110 001	Northern Rly., Baroda House, New Delhi – 01
पूर्वोत्तर रेलवे, गोरखपुर – 273 012	Northeastern Rly., Gorakhpur – 273 012
पूर्वोत्तर सीमान्त रेलवे, मालीगांव, गुवाहाटी – 780 011	North Frontier Rly., Maligaon, Guwahati – 011
दक्षिण रेलवे, पार्क टाउन, चेन्नई – 600 003	Southern Rly., Park Town, Chennai – 600 003
दक्षिण मध्य रेलवे, सिकन्दराबाद – 500 371	South Central Rly, Rail Nilayam, Secunderabad – 71
पूर्व मध्य रेलवे, हाजीपुर – 841 101	East Central Railway, Hazipur - 841 101
उत्तर पश्चिम रेलवे, जयपुर – 302 006	North Western Railway, Jaipur – 302 006
पूर्व तटीय रेलवे, ग्राउन्ड तल, उत्तरी ब्लॉक, समन्त विहार, भुवनेश्वर – 17	East Coast Railway, Rail Vihar, Ground Floor, North Block, Samant Vihar, Bhubaneswar – 17
उत्तर मध्य रेलवे, गंगा कॉम्प्लेक्स, सूबेदारगंज, इलाहाबाद	North Central Railway, Ganga Complex, Subedarganj, Allahabad.
दक्षिण पश्चिम रेलवे, मुख्य कार्यालय, क्लब रोड, केशवपुर, हुबली – 580 023	South Western Railway, Main Office, Club Road, Keshavpur, Hubli – 23
पश्चिम मध्य रेलवे, द्वितीय तल, डी.आर.एम. ऑफिस, जबलपुर – 482 001	West Central Railway, II <sup>nd</sup> Floor, DRM Office, Jabalpur – 482 001
दक्षिण पूर्व मध्य रेलवे, आर0ई0 ऑफिस कॉम्प्लेक्स, बिलासपुर – 495 004	South East Central Railway, R. E. Office Complex, Bilaspur – 495 004
मेट्रो रेलवे, 33/1, जवाहर लाल नेहरू रोड, कोलकाता – 700 071	Metro Railway, 33/1, Jawaharlal Nehru Road, Kolkata – 700071
कोर , नवाब युसुफ रोड, सिविल लाइन्स, इलाहाबाद – 211 001	CORE, Nawab Yusuf Road, Civil Lines, Allahabad – 211 001
निदेशक/इरिसेट, तारनाका रोड, लालागुडा, पी. ओ. सिकन्दराबाद – 17	Director/IRISET, Tarnaka Road Lallaguda, P.O. Secunderabad – 17

**Sub.:** Amendment No. 1 to RDSO Specification No. RDSO/SPN/204/2011 Version 1.1, for “Double Walled Corrugated HDPE Duct for Railway Signalling”.

\*\*\*\*\*

In Compliance to Vigilance Cell/RDSO's Letter No. 13/Vig/Policy dated 26.07.2016 & 08.09.2016, Amendment No. 1 to RDSO Specification No. RDSO/SPN/204/2011 Version 1.1, for “Double Walled Corrugated HDPE Duct for Railway Signalling” is hereby issued with the approval of competent authority for information & implementation please.



Encl. : Amendment No. 1 to RDSO Specification No.  
RDSO/SPN/204/2011 Version 1.1, for "Double  
Walled Corrugated HDPE Duct for Railway Signalling".

(V. K. Agarwal)  
Jt. Director/Signal-VIII  
for Director General/Signal

**Copy to:**

कार्यकारी निदेशक / गुणवत्ता आश्वासन / अ०अ०मा०सं०, लखनऊ	Executive Director/QA/S&T/RDSO/Lucknow
निदेशक / गुणवत्ता आश्वासन / सिगनल एवं दूरसंचार, / अ०अ०मा०सं०, निकट इरकॉट बिल्डिंग, शंकर मार्केट के पीछे, शिवाजी ब्रिज, नई दिल्ली – 110 001	Director/QA./S&T/RDSO, 1st Floor, Near IRCOT Building, Behind Shanker Market, Shivaji Bridge, New Delhi – 110 001
निदेशक / गुणवत्ता आश्वासन / संकेत एवं दूरसंचार, / अ०अ०मा०सं०, प्रथम तल, न्यू एनेक्सी बिल्डिंग, चर्चगेट, पश्चिम रेलवे, मुम्बई – 400 020	Director/QA./S&T/RDSO, 1st Floor, New Annexe Building., Western Railway, Churchgate, Mumbai – 400 020
निदेशक / गुणवत्ता आश्वासन / सिगनल एवं दूरसंचार, / अ०अ०मा०सं०, भूतल, डी०आर०एम० ऑफिस, बंगलोर – 560 023	Director/QA./S&T/RDSO, Ground Floor, DRM Office, Bangalore – 560 023
निदेशक / गुणवत्ता आश्वासन / सिगनल एवं दूरसंचार, / अ०अ०मा०सं०, चौथी मंजिल, 17 एन.एस. रोड, वेस्ट विंग, फेयरली प्लेस, कोलकाता – 700 001	Director/QA./S&T/RDSO, 4th Floor, 17 N.S. Road, West Wing, Fairlie Place, Kolkata – 700 001
निदेशक / गुणवत्ता आश्वासन / सिगनल एवं दूरसंचार, / अ०अ०मा०सं०, हसनपुरा रोड, जयपुर – 302 006	Director/QA/S&T/RDSO, Hasanpura Road, In Front of Railway Hospital, JAIPUR – 302 006

Encl.: Amendment No. 1 to RDSO Specification No.  
RDSO/SPN/204/2011 Version 1.1, for "Double  
Walled Corrugated HDPE Duct for Railway Signalling".

(V. K. Agarwal)  
Jt. Director/Signal-VIII  
for Director General/Signal



**Amendment No. 1**

**To**

**Specification No. RDSO/SPN/204/2011 Version 1.1**

**For**

**Double Walled Corrugated HDPE Duct for Railway Signalling**

Following new clause is added to the Specification No. RDSO/SPN/204/2011 Version 1.1 .

**Clause No. 17.0**

“All the provisions contained in RDSO’s ISO procedures laid down in Document No. QO-D-7.1-11 dated 19.07.2016 (titled “Vendor-Changes in approved status”) and subsequent versions/amendments thereof, shall be binding and applicable on the successful vendor/vendors in the contracts floated by Railways to maintain quality of products supplied to Railways.’

End of Amendment No. 1